



401 South Grand Ave., Santa Ana, CA 92705  
Tel: 714.550.6070 Fax: 714.550.9661 www.twobros.com

## KLX/DRZ110 "Over The Top" Rear Brake Lever



### Parts List

Qty.	Description	Part Number
1	Over the Top Brake Lever Assembly	022_7-01
1	M5 x 16mm Socket Head Cap Screw	
1	M5 Hex Nut	
1	Cotter Pin	

### IMPORTANT - PLEASE READ CAREFULLY

*We recommend that this performance part be installed by a qualified motorcycle technician. If you have any doubts as to your ability to install this performance part, please consult with your local motorcycle dealer. Read all instructions first before starting installation. Make sure the motorcycle and exhaust system are completely cool before starting the installation. Also, make sure the bike is secure on a centerstand or ideally a service lift during installation. Be sure to save all stock components for possible use later.*

### Warranty

Two Brothers Racing products are intended for closed course competition purposes only, and therefore are sold "as is" without warranty. Two Brothers Racing specifically disclaims any warranties of merchantability or fitness for a particular purpose and disclaims all responsibility for consequential and incidental damages or any other losses arising from the use of these products or parts.

### Installation Instructions

1. Make sure the bike is completely cool before starting the installation. Make sure the bike is secure on a centerstand or ideally a service lift.
2. Remove kick-start lever.
3. Completely remove existing brake lever.
3. Attach original brake return spring to Over the Top brake lever as shown.



Figure 1



Figure 2

4. Install original O-rings into new brake assembly as shown in Figure 3.

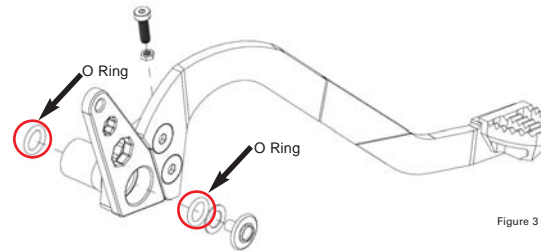

Figure 3

5. Slide brake lever assembly onto mounting pivot (a) and attach free end of spring to pin (b) shown in Figure 4. Set adjustment screw (c) so that brake lever is level with footpeg. When the appropriate lever position is reached, secure adjustment screw with locking nut. **Note:** Mounting pivot (a) must be straight. If mounting pivot is bent it can cause the brake lever to hit the engine casing.

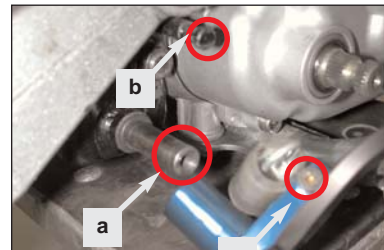

Figure 4

6. Attach existing brake rod through top mounting hole in new brake lever and replace existing cotter pin with supplied cotter pin, reusing your original washer. **Important: Never re-use an old cotter pin.**

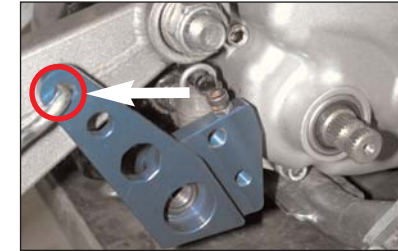

Figure 5

7. Install washer (3) and pivot bolt and torque pivot bolt to 8N/M.

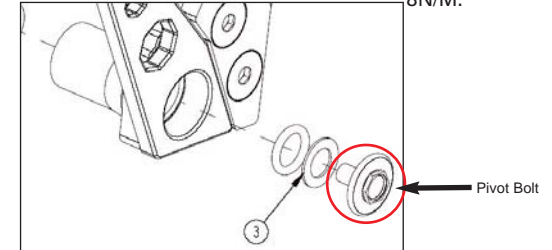

Figure 6

8. Install kick-start lever.



Figure 7



Completed Assembly